

Brick slip lintels

B section range 215 mm high

Section at span:

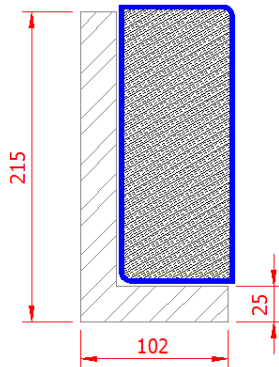

Section at bearing:

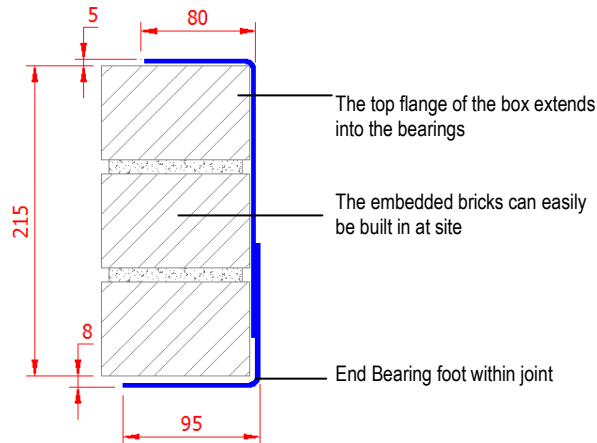

B215/3

Lintel section properties

lxx	744.7 cm ⁴
Zxx	77.2 cm ³
Weight	12.7 kg/m
Area	15.9 cm
Ryy	3.5 cm

B215/4

Lintel section properties

lxx	978.7 cm ⁴
Zxx	101.4 cm ³
Weight	16.8 kg/m
Area	21.0 cm
Ryy	3.5 cm

B215/6

Lintel section properties

lxx	1483.4 cm ⁴
Zxx	151.4 cm ³
Weight	25.3 kg/m
Area	31.6 cm
Ryy	3.5 cm

Lintel load Capacity Table

Opening Span	Lintel Length	Safe Load kN	Load Example
600	900	180.1	
900	1200	120.0	
1200	1500	90.0	
1500	1800	72.0	
1800	2100	60.0	
2100	2400	51.4	
2400	2700	44.6	
2700	3000	39.2	
3000	3300	32.5	Full height masonry
3300	3600	26.8	
3600	3900	22.6	1500 mm masonry
3900	4200	19.2	
4200	4500	16.6	
4500	4800	14.4	
4800	5100	12.7	
5100	5400	11.2	
5400	5700	10.0	
5700	6000	9.0	

Lintel load Capacity Table

Opening Span	Lintel Length	Safe Load kN	Load Example
600	900	236.6	
900	1200	157.8	
1200	1500	118.3	
1500	1800	94.7	
1800	2100	78.9	
2100	2400	67.6	
2400	2700	58.6	
2700	3000	51.6	
3000	3300	42.7	
3300	3600	35.3	
3600	3900	29.6	
3900	4200	25.3	1500 mm masonry
4200	4500	21.8	
4500	4800	19.0	
4800	5100	16.7	
5100	5400	14.8	
5400	5700	13.2	
5700	6000	11.8	

Lintel load Capacity Table

Opening Span	Lintel Length	Safe Load kN	Load Example
600	900	353.2	
900	1200	235.5	
1200	1500	176.6	
1500	1800	141.3	
1800	2100	117.7	
2100	2400	100.9	
2400	2700	87.6	
2700	3000	77.1	
3000	3300	64.7	
3300	3600	53.5	
3600	3900	44.9	Full height masonry
3900	4200	38.3	
4200	4500	33.0	
4500	4800	28.8	1500 mm masonry
4800	5100	25.3	
5100	5400	22.4	
5400	5700	20.0	
5700	6000	17.9	

The section provides a bearing on the top flange with a second bearing at the "foot". Full bricks are laid up to the gauged brick eliminating the need for slips on site. Default material stainless steel SS370 (EN 1.4003) also available in stainless steel LDX2101 (EN 1.4162). Loadings are shown above to assist you in your selection 102.5mm brickwork is 2.2 kN/m². Dimensions can be varied to suit imperial, other brick sizes and thicker slips